

Tax Year: 2025

Scale: 1:21333.37 Basemap: Cadastral Application Base Map

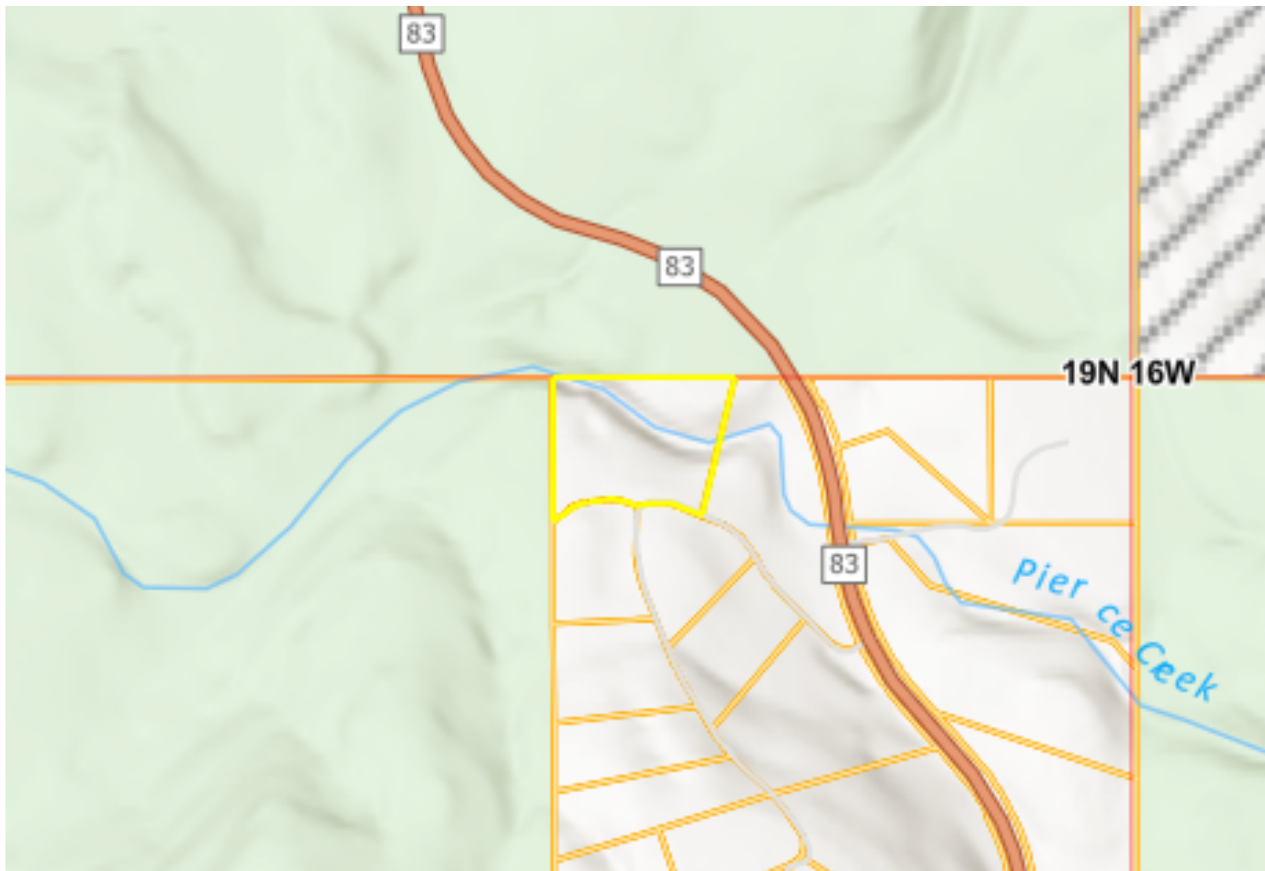

Summary

Primary Information

Property Category: RP

Subcategory: Residential Property

Geocode: 04-2873-21-1-02-03-0000

Assessment Code: 0001633203

Primary Owner:

DALTON JEFFREY L
5449 MT HIGHWAY 83 N
SEELEY LAKE, MT 59868-8600
Note: See Owners section for all owners

Property Address:

5449 HWY 83 N
SEELEY LAKE, MT 59868

Certificate of Survey: 338

Legal Description: S21, T19 N, R16 W, C.O.S. 338, PARCEL 1, IN NE4

Last Modified: 6/19/2025 12:32:1 PM

Cadastral Property Report

Tax Year: 2025

General Property Information

Neighborhood: 204.025	Property Type: Improved Property
Living Units: 1	Levy District: 04-1596-33-6
Zoning:	Ownership: 100
LinkedProperty: No linked properties exist for this property	
Exemptions: No exemptions exist for this property	
Condo Ownership: General: 0	Limited: 0

Property Factors

Topography: n/a	Fronting: n/a
Utilities: n/a	Parking Type: n/a
Access: n/a	Parking Quantity: n/a
Location: n/a	Parking Proximity: n/a

Land Summary

Land Type:	Acres:	Value:
Grazing	0	0
Fallow	0	0
Irrigated	0	0
Continuous Crop		
Wild Hay	0	0
Farmsite	0	0
ROW	0	0
NonQual Land	0	0
Total Ag Land	0	0
Total Forest Land	0	0
Total Market Land	9.03	0

Deed Information

Deed Date	Book	Page	Recorded Date	Document Number	Document Type
7/27/2015	948	137	7/31/2015		Warranty Deed
10/15/2003	0720	00105	N/A		

Owners

Party #1

Default Information:	DALTON JEFFREY L 5449 MT HIGHWAY 83 N SEELEY LAKE, MT 59868-8600
Ownership %:	100
Primary Owner:	Yes
Interest Type:	Conversion
Last Modified:	9/10/2015 9:17:7 AM

Tax Year: 2025

Party #2

Default Information:	DALTON JAIME 5449 MT HIGHWAY 83 N SEELEY LAKE, MT 59868-8600
Ownership %:	100
Primary Owner:	Yes
Interest Type:	Conversion
Last Modified:	9/10/2015 9:17:7 AM

Appraisals

Appraisal History

Tax Year	Land Value	Building Value	Total Value	Method
2024	148392	266180	414572	COST
2023	148392	260670	409062	COST

Market Land

Market Land Item #1

Method: Acre	Type: Primary Site
Width: n/a	Depth: n/a
Square Feet: n/a	Acres: 9.03
Class Code: 2101	Value: n/a

Dwellings

Dwelling #1

Dwelling Information

Dwelling Type SFR	Style 11 - Log	Year Built 1983
Residential Type: SFR	Style: 11 - Log	
Year Built: 1983	Roof Material: 5 - Metal	
Effective Year: n/a	Roof Type: 4 - Gambrel	
Story Height: 1.5	Attic Type: 0 - None	
Grade: 4	Exterior Walls: 4 - Log (not log over frame)	
Class Code: 3301	Exterior Wall Finish: 0 - Other	
Year Remodeled: 2012	Degree Remodeled: n/a	

Mobile Home Details

Cadastral Property Report

Tax Year: 2025

Manufacturer: n/a
Width: n/a
Model: n/a

Serial #: n/a
Length: n/a

Basement Information

Foundation: 2 - Concrete
Daylight: N
Quality: n/a

Finished Area: n/a
Basement Type: 0 - None

Heating/Cooling Information

Type: Non-Central

System Type: 7 - Electric Baseboard/Electric Radiant

Fuel Type: 4 - Electricity

Heated Area: n/a

Living Accomodations

Bedrooms: 3

Family Rooms: n/a

Full Baths: 2

Half Baths: n/a

Addl Fixtures: 3

Additional Information

Fire Places
Stories: n/a
Openings: n/a

Stacks: n/a
Prefab/Stove: 1

Garage Capacity: n/a

Cost & Design: n/a

Flat Add: n/a

% Complete: n/a

Description: n/a

Dwelling Ammenities

View: n/a

Access: n/a

Area Used in Cost

Basement: n/a

Addl Floors: n/a

First Floor: 864

Second Floor: n/a

Half Story: 648

Unfinished Area: n/a

Attic: n/a

SFLA: 1512

Depreciation Information

CDU: n/a

Physical Condition: Fair (6)

Desirability
Property: Fair (6)

Location: Average (7)

Depreciation Calculation

Age: 41

Pct Good: 0.55

RCNLD: n/a

Additions / Other Features

Cadastral Property Report

Tax Year: 2025

Lower Addtns	First	Second	Third	Area	Year	Cost
	33 - Deck, Wood			144	0	0
	11 - Porch, Frame, Open			168	0	0
		11 - Porch, Frame, Open		144	0	0
No additional features exist for this property						

Other Buildings

Outbuilding/Yard Improvement #1

Type: Residential	Description: RRS1 - Shed, Frame
Quantity: 1	Year Built: 2003
Grade: L	Condition: Res Average
Functional: n/a	Class Code: 3301

Dimensions

Width/Diameter: 8	Length: 10
Size/Area: 80	Height: n/a
Bushels: n/a	Circumference: n/a

Outbuilding/Yard Improvement #2

Type: Residential	Description: AAL1 - Lean-to, 1 story, pole frame
Quantity: 1	Year Built: 2003
Grade: A	Condition: Res Average
Functional: n/a	Class Code: 3301

Dimensions

Width/Diameter: 10	Length: 20
Size/Area: 200	Height: n/a
Bushels: n/a	Circumference: n/a

Outbuilding/Yard Improvement #3

Type: Residential	Description: AAP4 - Pole Frame Bldg, 1 side open, wood
Quantity: 1	Year Built: 2010
Grade: A	Condition: Res Average
Functional: n/a	Class Code: 3301

Dimensions

Width/Diameter: 10	Length: 12
Size/Area: 120	Height: n/a
Bushels: n/a	Circumference: n/a

Tax Year: 2025

Outbuilding/Yard Improvement #4

Type: Residential	Description: RRG3 - Garage, frame, detached, unfinished
Quantity: 1	Year Built: 2011
Grade: 4	Condition: Res Average
Functional: n/a	Class Code: 3301

Dimensions

Width/Diameter: 40	Length: 50
Size/Area: 2000	Height: 16
Bushels: n/a	Circumference: n/a

Outbuilding/Yard Improvement #5

Type: Residential	Description: RRG3 - Garage, frame, detached, unfinished
Quantity: 1	Year Built: 1982
Grade: 3	Condition: Res Fair
Functional: n/a	Class Code: 3301

Dimensions

Width/Diameter: 20	Length: 20
Size/Area: 400	Height: n/a
Bushels: n/a	Circumference: n/a

Outbuilding/Yard Improvement #6

Type: Residential	Description: RRC2 - Patio Cover
Quantity: 1	Year Built: 2023
Grade: 5	Condition: Res Average
Functional: n/a	Class Code: 3301

Dimensions

Width/Diameter: n/a	Length: n/a
Size/Area: 874	Height: n/a
Bushels: n/a	Circumference: n/a

Commercial

No commercial buildings exist for this parcel

Ag/Forest Land



Cadastral Property Report

Tax Year: 2025

No ag/forest land exists for this parcel

Easements

No easements exist for this parcel

Disclaimer

The Montana State Library (MSL) provides this product/service for informational purposes only. MSL did not produce it for, nor is it suitable for legal, engineering, or surveying purposes. Data from disparate sources may not be in vertical alignment. Consumers of this information should review or consult the primary data and information sources to ascertain the viability of the information for their purposes. The MSL provides these data in good faith and in no event, shall be liable for any incorrect results or analysis, any lost profits and special, indirect or consequential damages to any party, arising out of or in connection with the use or the inability to use the data or the services provided. The MSL makes these data and services available as a convenience to the public, and for no other purpose. The MSL reserves the right to change or revise published data and/or services at any time.